

FRONT BRAKE (DISC) REMOVAL/INSTALLATION

B3E041133980W04

1. Remove in the order indicated in the table.
2. Install in the reverse order of removal.
3. After installation, pump the brake pedal a few times and verify that the brakes do not drag.

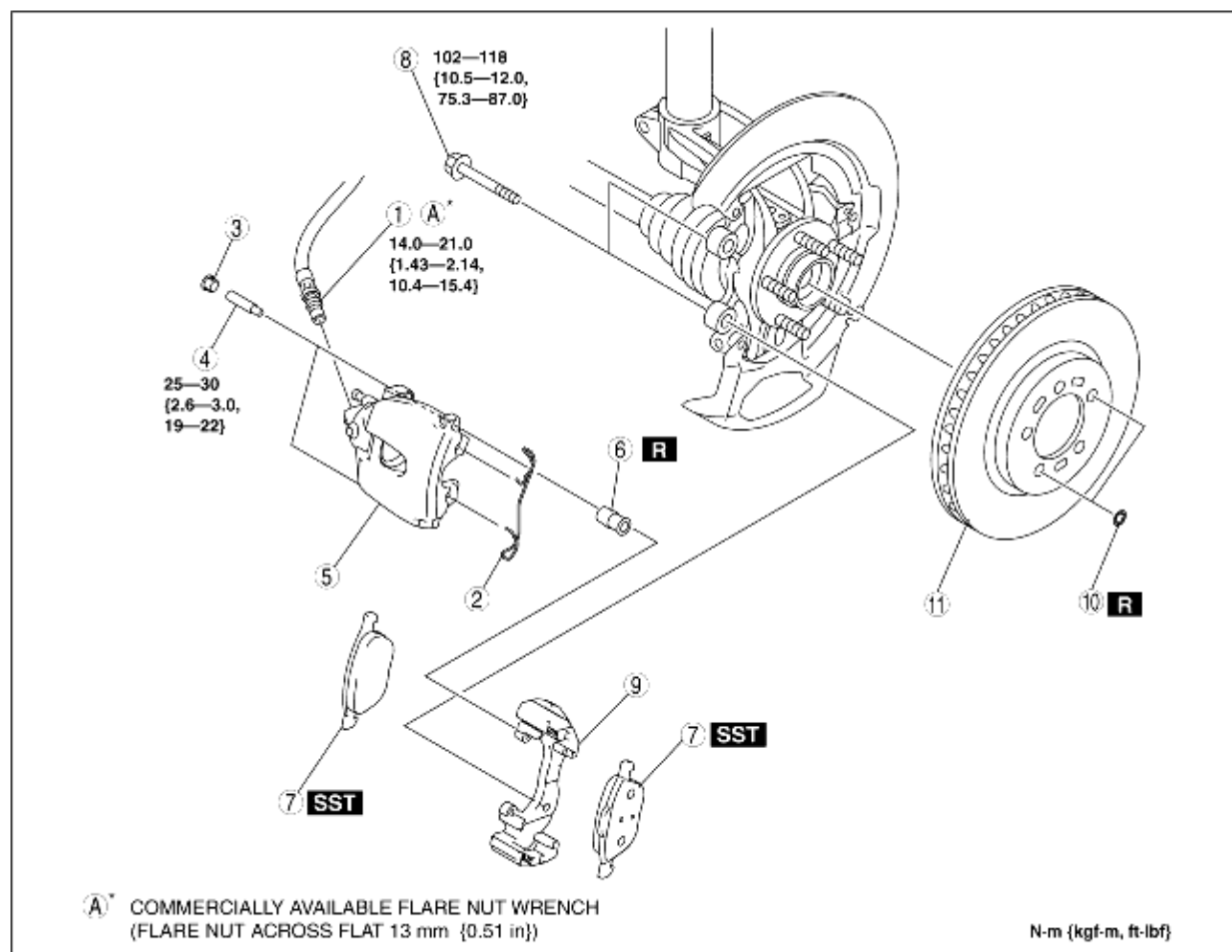

B3E0411W119

1	Brake hose (See Brake Hose Installation Note.)
2	Retaining clip
3	Cap
4	Bolt
5	Caliper
6	Boot
7	Disc pad (See Disc Pad Installation Note.)

8	Bolt
9	Mounting support
10	Washer
11	Disc plate

Disc Pad Installation Note

1. Clean the exposed area of the piston.
2. Push the piston in using the **SST**.

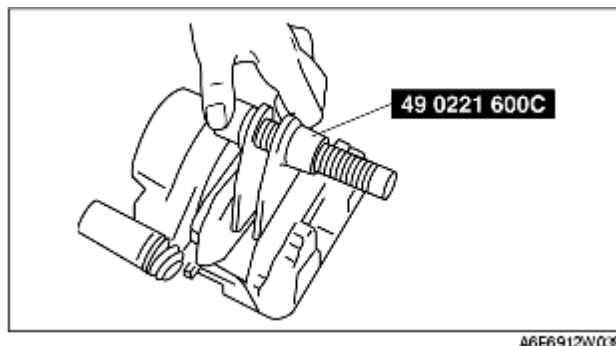

3. Install the disc pad (outer side) to the mounting support.
4. Install the disc pad (inner side) to the caliper.

Brake Hose Installation Note

1. Install the brake hose to the caliper.
2. Tighten the flare nut while holding the brake hose at point A with a spanner or equivalent.

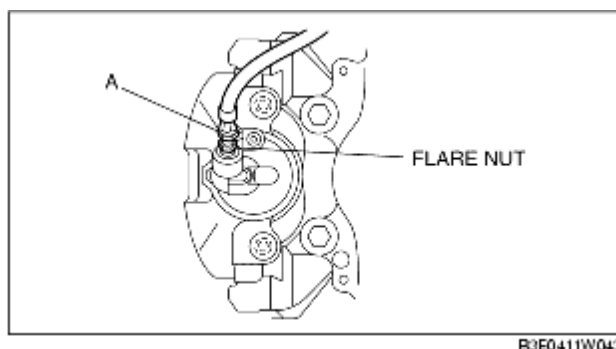

3. Verify that the brake hose is not twisted.